

LOCATION SKETCH

573-585 Pacific Highway KILLARA 2071

DEVELOPMENT APPLICATION No.0925/10

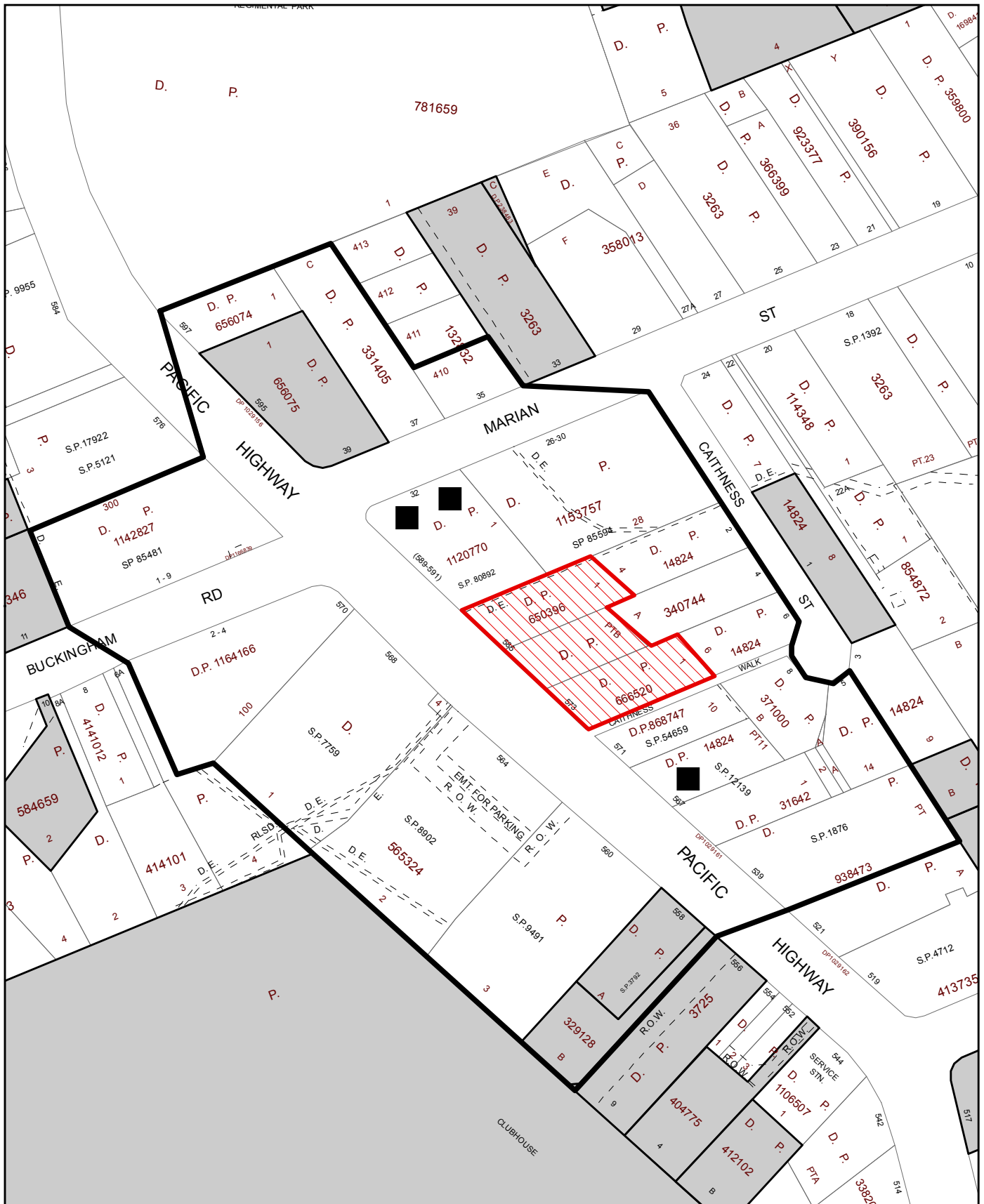

NORTH

DATE: 12-7-2011

0 5 10 20 30 40 Metres

- ▲ AGREEMENT
- OBJECTION
- ▣ PETITION
- SUBMISSION

- ▨ SUBJECT LAND
- HERITAGE ITEM
- ▨ CONSERVATION AREA
- ▨ CIRCULATED AREA

Ku-ring-gai Council

